

dBA UL-EPDM

Heavy Mass Layer

Description

The dBA UL-EPDM is an EPDM based heavy mass sound barrier. It can be used independently or incorporated into a multi-layered construction scheme. Due to its thinness, it is easily integrated or fitted in building layers (floor, ceiling or wall). Therefore, this product offers a significant weight increase with little space occupation, while improving the structure's overall sound insulation.

Specifications

Material:
EPDM

Dimensions:
 - **Rolls**
 5000 x 1000 (mm)
 - **Boards**
 1400 x 1000 (mm)

Installation:
Mechanical /Chemical

Technical Information

		Value	Standard
Dimensions [mm]	Rolls	1000 x 5000	-
	Boards*	1000 x 1400	-
Thickness [mm]	EPDM 3.5	1,90 (± 0,5)	-
	EPDM 5	2,75 (± 0,5)	-
	EPDM 10	5,5 (± 0,5)	-
Mass [kg/m²]	EPDM 3.5	3,5 (± 5%)	-
	EPDM 5	5 (± 5%)	-
	EPDM 10	10 (± 5%)	-
Fire Rate		-**	EN 13501-1

* EPDM 10 only comes in boards. Self adhesive boards of all versions available.
 ** Euroclass B-s1d0 UL-EPDM 5 available, upon request.

Acoustic Performance

	UL-EPDM 3.5	UL-EPDM 5	UL-EPDM 10
Impact Sound Reduction*	= 16 dB	= 17 dB	= 21 dB

* ΔLw measured with UL-EPDM applied under a floating 50mm concrete floor and over a 150mm thick concrete slab.

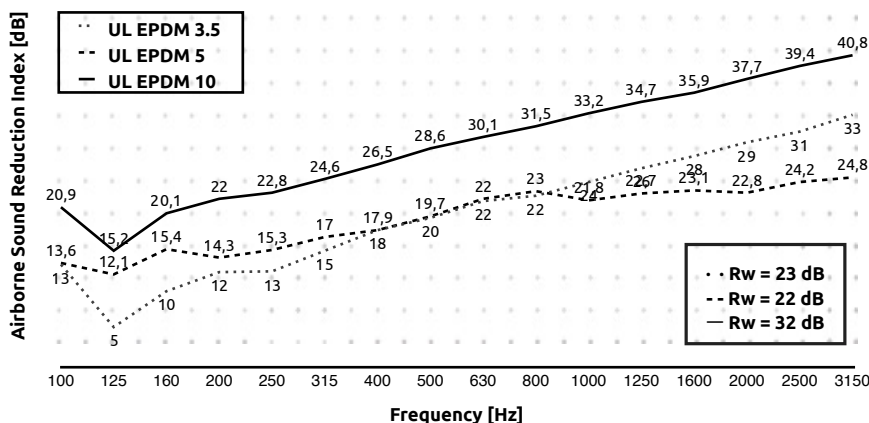

Applications

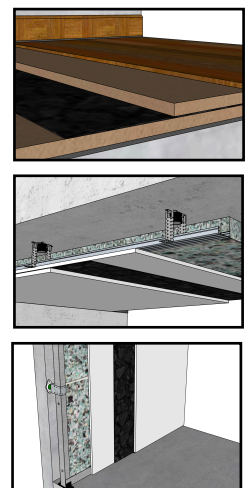

hello@artnovion.com
www.artnovion.com